

CLAMPING OPTIONS

(One or more of these may be included in this box)

Note that over-tightening of clamp may deform tube, cause binding of actuator and void the warranty

Standard Tube Mounting Clamp

- Position clamp onto tube.
- Tighten (4) bolts around clamp ball swivel until all loose motion is removed. ***Do not over-tighten.*** Clamp should be able to swivel smoothly.
- Tighten the (2) outside bolts on the clamp to 140 in-lbs max.

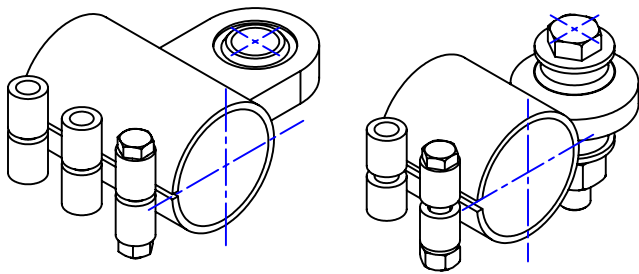
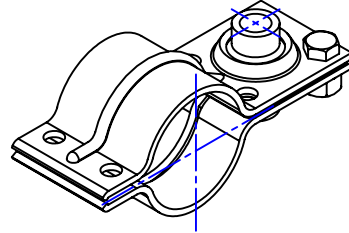

Heavy Duty Tube Mounting

- Position clamp onto tube.
- Tighten bolts uniformly to 125 in-lbs max. ***Do not over-tighten.*** Overtightening will deform actuator tube.

In-Line Bracket

- Position bracket halves around tube and gearbox.
- Tighten (4) bolts around tube end of bracket to 140 in-lbs max.

