

| DET. # | VENTURE # | REQ'D. | DESCRIPTION |
|--------|-----------|--------|-----------------------|
| 1 | 801 | 1 | OUTER TUBE |
| 2 | 802 | 1 | INNER TUBE |
| 3 | 1012 | 1 | ACME SCREW |
| 4 | 716 | 1 | DRIVE COUPLING |
| 5 | 819-03 | 2 | THRUST BEARING |
| 6 | 1020-01 | 1 | DRIVE PIN |
| 7 | 803 | 2 | WASHER |
| 8 | 1305 | 1 | SPACER |
| 9 | 825 | 2 | TRUNNION |
| 10 | 811 | 1 | JACK NUT |
| 11 | 838 | 1 | TUBE PILOT GUIDE |
| 12 | 812-F | 1 | 1/2" FLAT END MOUNT |
| 13 | 1020-08 | 2 | PIN |
| 14 | 804-00 | 1 | PILOT WASHER |
| 15 | 803-07 | 1 | WASHER |
| 16 | 816 | 1 | END MOUNT |
| 17 | 810 | 1 | 1/2" BALL SWIVEL STUD |
| 18 | 826 | 1 | SWIVEL BALL |
| 19 | 820 | 1 | 3/4" SWIVEL END MOUNT |
| 20 | 824 | 1 | 3/4" BEARING SWIVEL |
| 21 | 837 | 1 | TUBE BOOT |
| 22 | 830 | 1 | END MOUNT (STUD TYPE) |
| 23 | 831 | 1 | THREADED STUD |

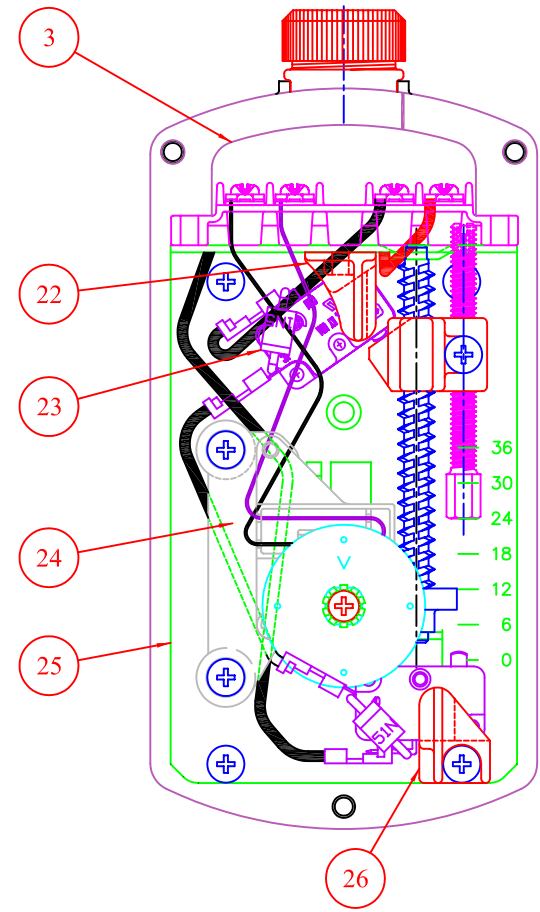
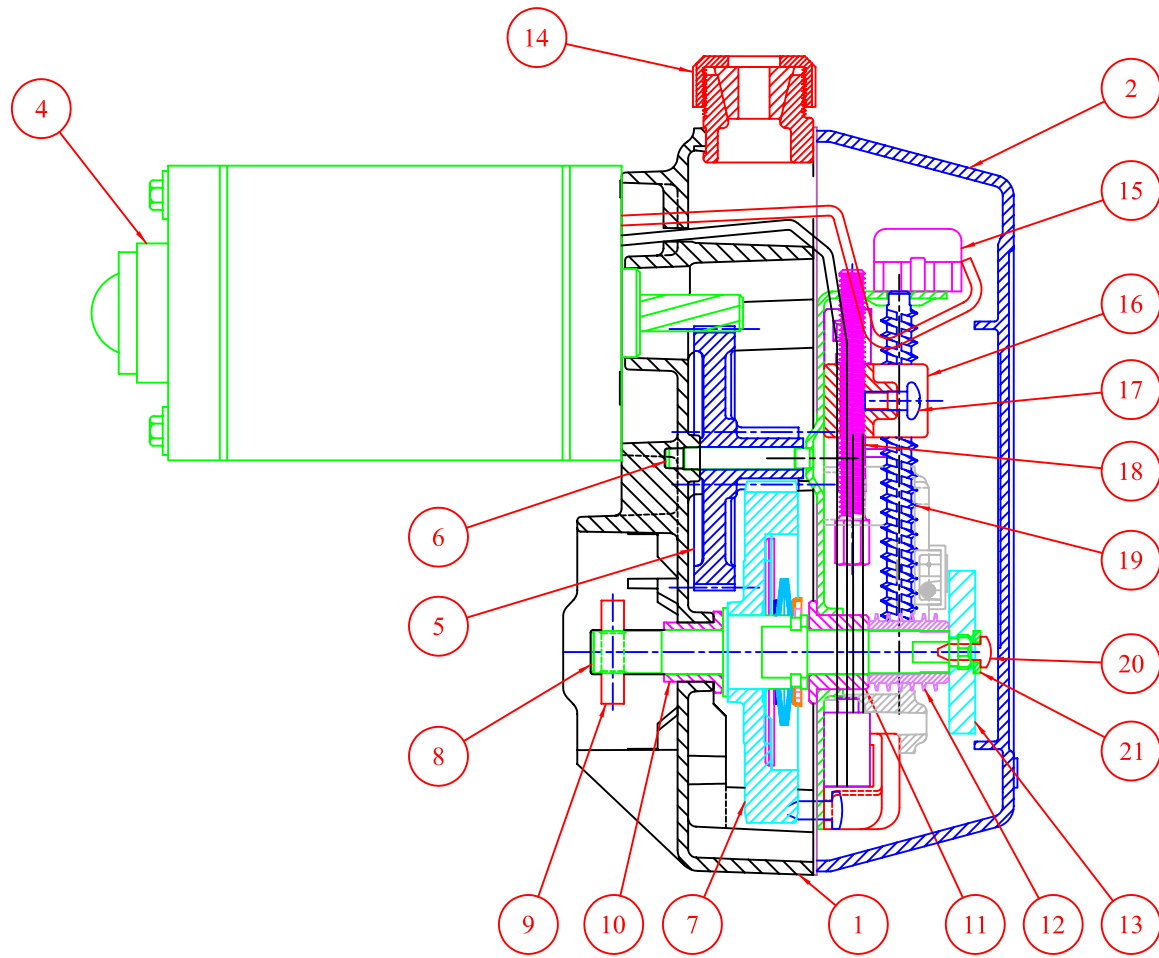

| DET. # | VENTURE # | REQ'D. | DESCRIPTION |
|--------|-----------|--------|---|
| 1 | 8501 | 1 | GEAR MOTOR HOUSING |
| 2 | 8502 | 1 | GEAR MOTOR LID |
| 3 | 8520 | 1 | GASKET |
| 4 | 8532-08M | 1 | 12 VDC MOTOR |
| | 8532-09A | 1 | 24 VDC MOTOR |
| | 8532-01 | 1 | 36 VDC MOTOR |
| | 8532-10A | 1 | 90 VDC MOTOR |
| | 8532-11A | 1 | 110 VDC MOTOR |
| 5 | 8504-01 | 1 | REDUCTION GEAR FOR 18:1 |
| | 8504-02 | 1 | REDUCTION GEAR FOR 28:1 |
| | 8504-03 | 1 | REDUCTION GEAR (OVERMOLD) FOR 58:1 |
| | 8504-05 | 1 | REDUCTION GEAR (METAL) FOR 58:1 |
| 6 | 8507 | 1 | SHAFT, REDUCTION GEAR |
| 7 | 8574-00 | 1 | OUTPUT GEAR (PM, CLUTCH) FOR 18:1 |
| | 8574-02 | 1 | OUTPUT GEAR (PM, CLUTCH) FOR 28:1 |
| | 8574-01 | 1 | OUTPUT GEAR (PM, CLUTCH) FOR 58:1 |
| | 8503-04 | 1 | OUTPUT GEAR (NO CLUTCH) FOR 58:1 |
| 8 | 8505-00 | 1 | OUTPUT SHAFT W/OUT CLUTCH (B.S.) |
| | 8505-01 | 1 | OUTOUT SHAFT W/OUT CLUTCH (ACME) |
| | 8575-00 | 1 | OUTPUT SHAFT W/CLUTCH (ACME) |
| | 8575-04 | 1 | OUTPUT SHAFT W/CLUTCH (B.S.) |
| 9 | 1020 | 1 | SPIROL PIN |
| 10 | 8514 | 1 | FLANGE BUSHING |
| 11 | 8514 | 1 | FLANGE BUSHING |
| 12 | 8509-00 | 1 | DRIVE WORM, R.H. SINGLE START, BLACK |
| | 8509-01 | 1 | DRIVE WORM, L.H. SINGLE START, RED |
| | 8509-02 | 1 | DRIVE WORM, L.H. DOUBLE START, BRASS |
| 13 | 8524-00 | 1 | MAGNET WHEEL, 4 POLE |
| | 8524-01 | 1 | MAGNET WHEEL, 8 POLE |
| | 8524-02 | 1 | MAGNET WHEEL, 6 POLE |
| 14 | 8530-00 | 1 | STRAIN RELIEF ASSEMBLY (INCL. BUSHINGS) |
| 15 | 8525 | 1 | TERMINAL STRIP |
| 16 | 8511-00 | 1 | LEADSCREW NUT, BLACK |
| | 8511-01 | 1 | LEADSCREW NUT, RED |
| 17 | 8518-02 | 1 | #8 X .38 LONG P.P.H. SCREW |
| 18 | 8512 | 1 | ADJUSTING ROD |
| 19 | 8510-01 | 1 | LEADSCREW, 12 PITCH, ALUMINUM |
| | 8510-02 | 1 | LEADSCREW, 18 PITCH, STL. (BRITE ZINC) |
| | 8510-03 | 1 | LEADSCREW, 8 PITCH, ZINC (STANDARD) |
| 20 | 8518-04 | 1 | #6 X .38 LONG P.P.H. SCREW |
| 21 | 803-05 | 1 | #8 EXTERNAL STAR WASHER |
| 22 | 8516-00 | 1 | LIMIT SWITCH CLIP, RETRACT |
| 23 | 8526 | 1 | LIMIT SWITCH ASSEMBLY |
| 24 | 8101-00 | 1 | SUPER SENSOR II |
| | 8102-00 | 1 | HALL EFFECT SENSOR |
| | 8529 | 1 | POTENTIOMETER SENSOR KIT |
| 25 | 8506 | 1 | GEAR PLATE |
| 26 | 8517-00 | 1 | LIMIT SWITCH CLIP, EXTEND |